



QUALITY & INNOVATION IN EVERY LOCK.

Qi-EKF002

Suitable for metal, wooden or laminate doors

Material: Zinc Alloy, ABS

Finish: Electroplated brushed nickel, painted iron grey

Suitable door thickness: 0.6 - 20 mm

- A robust, heavy duty Electronic Keypad lock with a concealed master key + master code override and emergency power slot
- Can also be operated by finger print by both management and users
- Tough reinforced zinc alloy body for maximum strength and durability
- Fitted with an alarm to warn of tampering or wrong code input
- Long battery life with low power warning system
- Power safe memory that retains all settings during battery changes to avoid any data loss
- Can be set to private or public mode with occupancy indicator
- State of the art anti-theft technology with fake code option that can be used for privacy (correct code is contained within a longer fake code)
- Dual-level security with separate management and user access codes
- Versatile mounting options and accessories to suit any application with various cams available
- Available with a threaded barrel with a cam or a slam shut box (specify at point of order)
- Vertical and horizontal options available

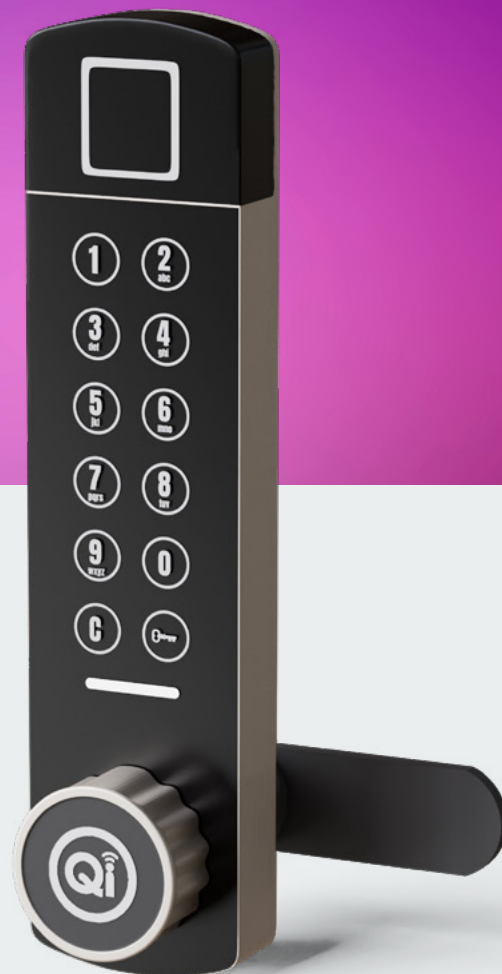
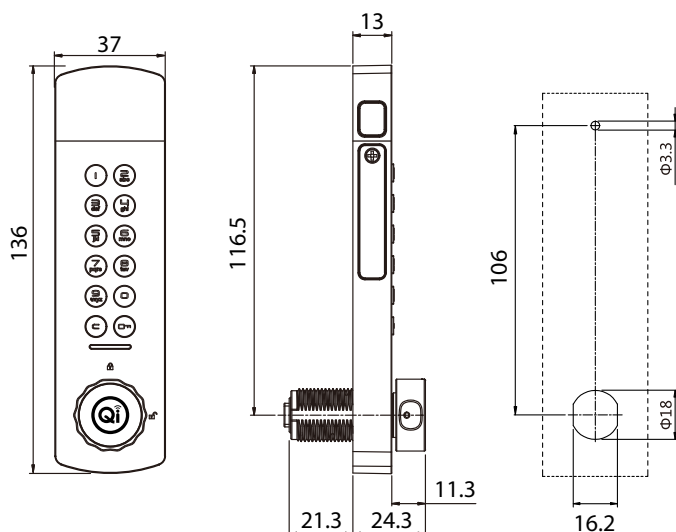

Installation

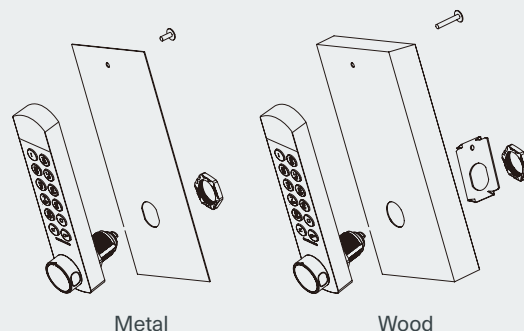

Optional accessories

